

# Maestro 2.50 NxT

Electro-mechanical 2-post lift, 5.0 t capacity



## Application

- Repair and maintenance

## Description:

### Posts:

- Symmetric post installation
- Very stable welded posts
- Without base frame, therefore free drive-in situation
- Two strong electric motors
- Cold-rolled spindles for high durability
- Nylon nut sets for high durability
- Carriage with 6 guiding wheels and lubrication-free roller bearings, for very low friction
- Obstruction system for stopping the lift if it hits an obstacle
- Pushbutton control unit with alarm signal
- Programmable limit switch for top stop and CE-stop
- Electronic synchronization through comparison of pulses on both columns

### Arms:

- Double telescopic arms in front and rear
- Internal arm locking system
- Low minimum height

### Standard colours:

- Carriage and arms: RAL 3020 – red
- Posts: RAL 7016 – grey

## Versions:

- Available with different voltages
- F = flex pad
- DT/DT = double telescopic arms in front and rear
- 50 mm Ø hole for lifting pads incl. adapter for reduction to Ø 40 mm

## Optional extras:

- Available with different portal heights, alternatively inground kit
- Set of expansion bolts
- LED-lighting set
- Energy set with compressed air and socket-outlet
- Extra control unit for second column
- Wheel supports
- Large program of extra pads, depending on type of vehicle

**Special colours available on request!**



Scan the QR-Code for detailed product information.

Further Information on [www.autopstenhoj.com](http://www.autopstenhoj.com)

**AUTOPSTENHOJ GmbH**

Sandkampstraße 90  
D-48432 Rheine  
☎ +49 5971 8602-02  
✉ info@autopstenhoj.com

**AUTOPSTENHOJ GmbH**

Barrit Langgade 188-190  
DK-7150 Barrit  
☎ +45 76 82 13 30  
✉ info@autopstenhoj.com

Technical data	
Lifting capacity	5,000 kg
Lifting height	1,900 mm
Working height	F DT/DT: 2,012 - 2,048 mm
Lifting / lowering time	approx. 55 sec.
Motor	2 x 2.8 kW
Voltage	3x230/400 V-50Hz - 25A

Arm superstructure	
Insertion height in swivel arm	75 mm
Lifting pad included in the delivery (item 770505)	F: 30 - 60 mm
Min. height	112 mm
Drive-through width	2,838 - 3,038 mm
Width between posts	3,238 - 3,438 mm
Total width - outer edges base plates	4,000 - 4,200 mm *
Total height post	2,912 mm
Total height incl. Portal	4,885 - 5,245 mm
Arm length front, min. - max.	F DT/DT: 906 - 1,926 mm
Arm length rear, min. - max.	F DT/DT: 906 - 1,926 mm

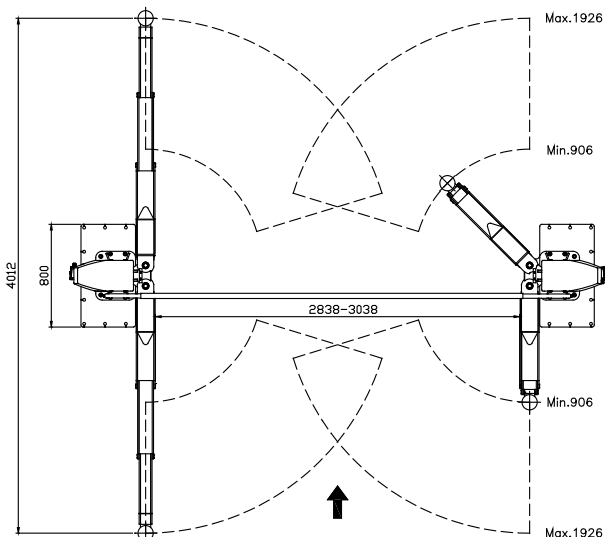
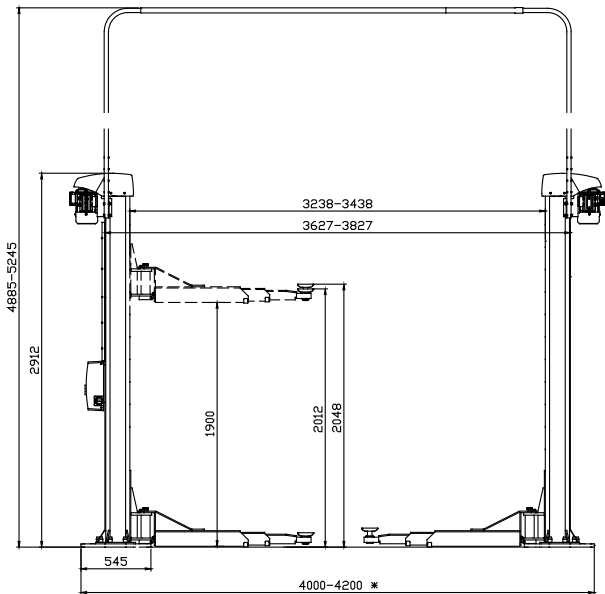
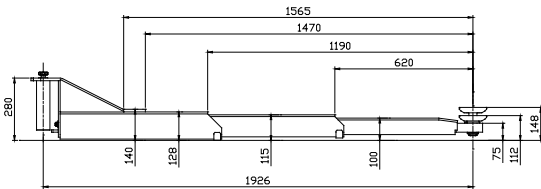

\* 4,000 mm: recommended if primarily vans are to be lifted.  
4,200 mm: recommended for a universal lifting area, with focus on passenger cars



Stable, welded post



Double telescopic arm with F-pad



Nylon nut sets